

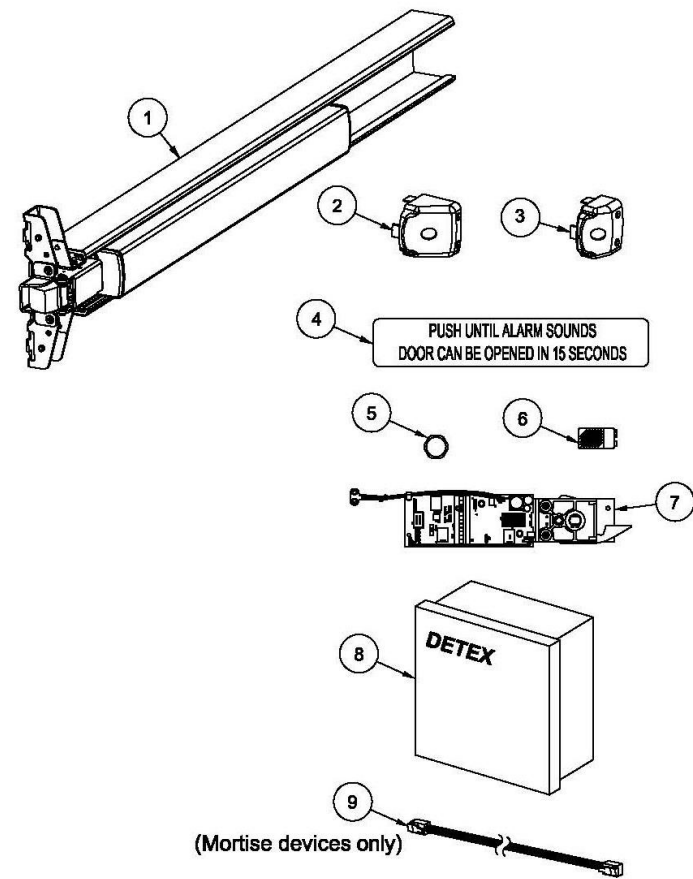

EE Parts List



Item	Order Part#	Description	Price
1	105500-17	Centercase/Pushpad SubAssembly, 10 series, 36", 630 finish, CD	\$795.53
	105500-111	Centercase/Pushpad SubAssembly, 10 series, 48", 630 finish, CD	\$838.41
	100550-30	Centercase/Pushpad SubAssembly, RHR 20 series, 36", 630 finish, CD	\$810.69
	105500-34	Centercase/Pushpad SubAssembly, RHR 20 series, 48", 630 finish, CD	\$838.41
2	102095-9	EC1 Endcap, 630 finish (drilled for Flex Conduit)	\$157.00
3	104686-1	EC2 Endcap, Aluminum, Aluminum painted (drilled for Flex Conduit)	\$130.00
	104317-9	EC2 Endcap, Aluminum, Aluminum painted (drilled for Flex Conduit)	\$128.00
4	ECL-395	Door Sign, 15 second delayed egress	\$19.00
	ECL-395-1	Door Sign, 15 second delayed egress	\$19.00
5	100783	Hex Nut (for cylinder installation)	\$8.00
6	PP-5567	9V Battery	\$11.00
7	104494-2	Advantex EE dogging assembly, Rim, 15/15	\$403.00
	104494-8	Advantex EE dogging assembly, Rim, 1/15 SA	\$402.00
	105035-2	Advantex EE dogging assembly, SVR, CVR, 15/15	\$514.00
	105035-7	Advantex EE dogging assembly, SVR, CVR, 15/15 SA	\$444.00
	105035-8	Advantex EE dogging assembly, SVR, 1/15 SA	\$444.00
	105034-2	Advantex EE dogging assembly, Mortise, 15/15	\$567.00
8	90-800	90-800 Power Supply	\$777.00
	103306-2	Raceway cable, 3-0 (Mortise device only)	\$88.00
9	103306-3	Raceway cable, 4-0 (Mortise device only)	\$93.00

NOTE: Your particular part or configuration may not be shown: Contact Detex technical support at 800-729-3839 (option 2)

March 8, 2023

